

1,500 GALLON 2-PIECE SEPTIC TANK

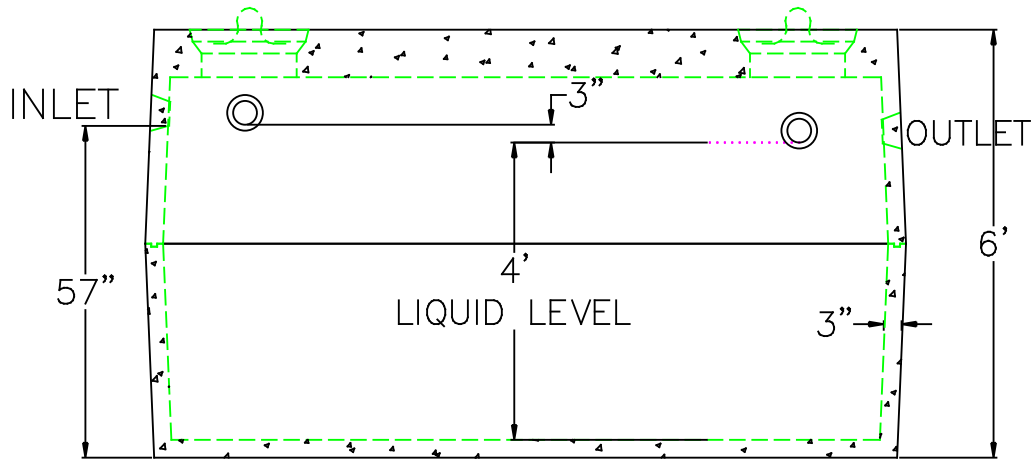
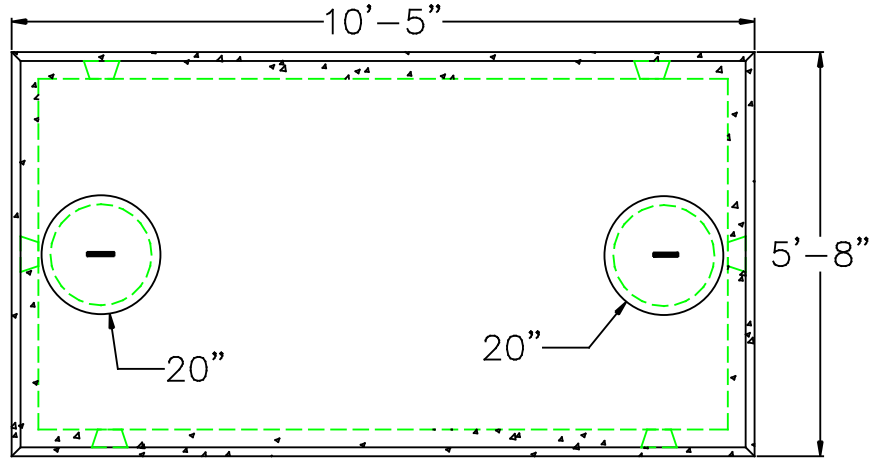

DESIGN NOTES:

1. CONCRETE 4,000 PSI @ 28 DAYS
2. TANK COMPLETELY REINFORCED
3. TOP & BOTTOM MATCHING KEY JOINT
4. AVAILABLE IN H-10 & H.D. TOPS

	FLOOR	VERT. FT	COVER
WEIGHT	2,200 lbs.	1,150 lbs.	3,600 lbs.
VOLUME		375 gal.	



NPCA

Precast ... The Concrete Solution.



**SCITUATE
COMPANIES**

SCITUATE RAY PRECAST
120 CLAY PIT ROAD
MARSHFIELD, MA 02050
PHONE # 1-800-440-0009
FAX # 781-837-4320

CONTRACTOR:

JOB NAME:

DATE:

DRAWING: SRP-ST1.5K

DRAWING BY: C. J. SCOTT

WWW.SCITUATECOMPANIES.COM