

12"-24" RCP MORTAR JOINT REINFORCED

DESIGN NOTES:

1. MFG. IN ACCORDANCE WITH ASTM SPEC. C76 & AASHTO SPEC. M170, WALL B.
2. CEMENT TYPE II
3. CONCRETE STRENGTH CLASS III & IV 4,000 psi CLASS V 6,000 psi
4. CIRCUMFERENCE REINFORCEMENT:

12" CLASS III	0.07 Sq. in. per ft.
12" CLASS IV	0.07 Sq. in. per ft.
12" CLASS V	0.10 Sq. in. per ft.
15" CLASS III	0.07 Sq. in. per ft.
15" CLASS IV	0.10 Sq. in. per ft.
15" CLASS V	0.14 Sq. in. per ft.
18" CLASS III	0.07 Sq. in. per ft.
18" CLASS IV	0.14 Sq. in. per ft.
18" CLASS V	0.19 Sq. in. per ft.
21" CLASS III	0.07 Sq. in. per ft.
21" CLASS IV	0.20 Sq. in. per ft.
21" CLASS V	0.24 Sq. in. per ft.
24" CLASS III	0.10 Sq. in. per ft.
24" CLASS IV	0.27 Sq. in. per ft.
24" CLASS V	0.30 Sq. in. per ft.

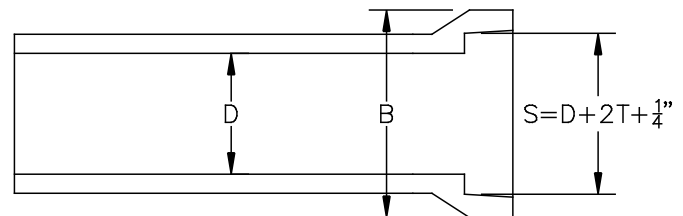
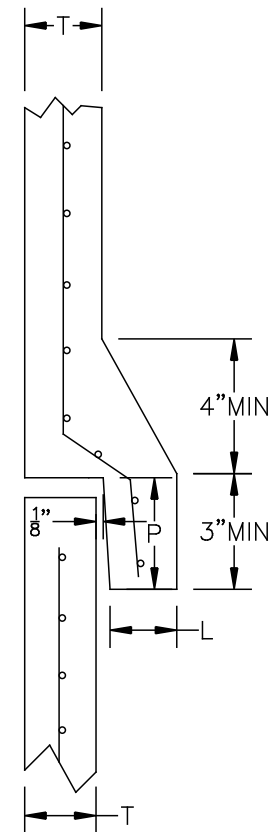

D	T	B	S	P	L
DIA.	MIN. DIMENSIONS, INCHES				
12	2	20	16.25	2.5	1.5
15	2.25	23.875	19.75	2.5	1.6875
18	2.5	27.75	23.25	2.75	1.875
21	2.75	31.625	26.75	2.75	2.0625
24	3	35.5	30.25	3	2.25



NPCA

Precast ... The Concrete Solution.



**SCITUATE
COMPANIES**

SCITUATE CONCRETE PIPE
P.O. BOX 870 * 1 BUCKEYE LANE
SCITUATE, MA 02066
PHONE # 1-800-322-4488
FAX # 781-545-6021

CONTRACTOR:

JOB NAME:

DATE:

APPROVED BY:

DRAWING BY: C.J. SCOTT

WWW.SCITUATECOMPANIES.COM